

## Delivery Program Pumps

### Applications

GFT German Fluorolined Technik GmbH products are **Made in Germany**. Our pumps and valves are successfully used for handling highly corrosive, ultra-pure or environmentally critical media in the chemical, fine-chemical, pharmaceutical and petrochemical process industry, but also food and beverage, semi-conductor, fragrance & flavours, pulp & papier industry, base metals and general industry, waste and recycling industry.

### AlMagnon CP

Magnet Drive Processpump PFA Lined

Performance data: Up to 80m<sup>3</sup>/h, up to 60m

Temperature: -10°C up to +150°C

Design pressure: 16bar

Hydraulics: 4

Materials: 1.0619/PFA, SSiC

Dimensions: ISO 2258/EN 22858

Design: ISO 5199

Flanges: Drilled acc. to DIN, BS, ANSI, JIS

Close coupled or frame mounted version

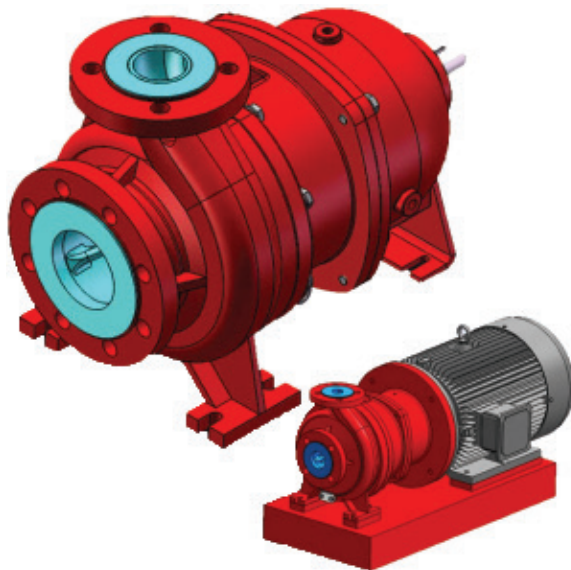

### Plain Bearing

The plain bearing is the heart of any mag drive pump. We have therefore carefully designed the flushing circuit to assure the lubrication of the plain bearings. CFD (computational fluid dynamics) methods blended with our vast experience of more than 40 years of developing magnetic drive pumps were applied to design the flushing circuit to assure a reliable pumping even under most demanding operating conditions.

### AlMagnox CP

Magnet Drive Processpump Metal

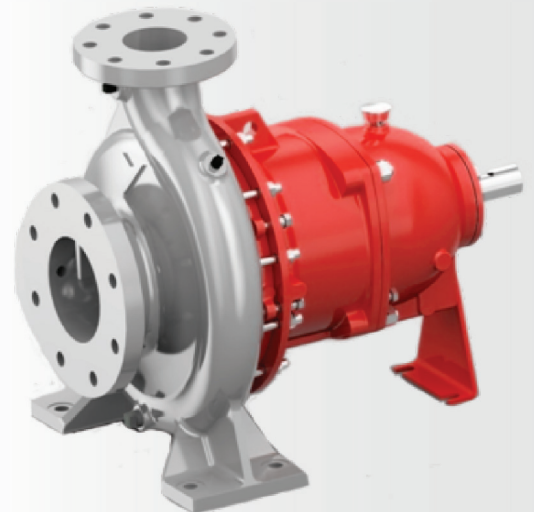

Performance data: Up to 300m<sup>3</sup>/h, up to 150m

Temperature: -50°C up to +180°C

Design pressure: 16bar

Hydraulics: 22

Materials: 1.4408, Duplex, Super Duplex, ALLOY 20, Hastelloy B and C

Dimensions: ISO 2258/EN 22858

Design: ISO 5199

Flanges: Drilled acc. to DIN, BS, ANSI, JIS

Close coupled or frame mounted version

Pumps with magnet drive: Hermetic safe & environmentally friendly thanks to contact free magnetic-coupling instead of wearing mech seal

Magnet drive handle solids up to 5% and 0,3mm particle size, gas contents up to 2%

Double pack-pull out bearing bracket

Extremely low life-cycle costs are a common feature to all GFT products

Large range of high performance thermo plastics, highly flexible transfermolding

GFT in-house transfermolding and tool manufacturing assure highest quality

Lined Pumps: Casing A216 WCB (1.0619), optional CF8-M (1.4408)

## SEALNOX CP

Chemical Processpump with Mechanical Seal

Performance date: Up to 2.000m<sup>3</sup>/h, up to 225m

Temperature: -50°C up to +350°C

Design pressure: 16bar

Hydraulics: 43

Materials: 0.6025, 1.4408, Duplex, Super Duplex, ALLOY 20, Hastelloy B and C

Dimensions: ISO 2258/EN 22858

Design: ISO 5199

Flanges: Drilled acc. to DIN, BS, ANSI, JIS

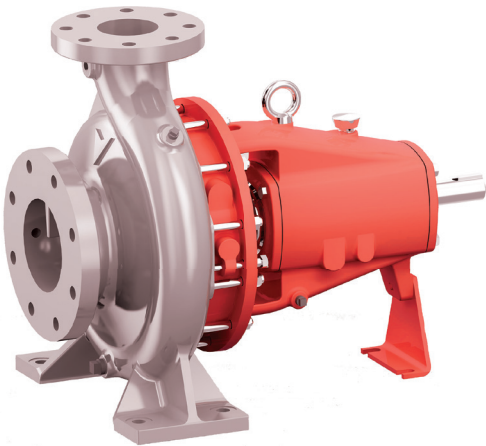

## SEALNOX WP

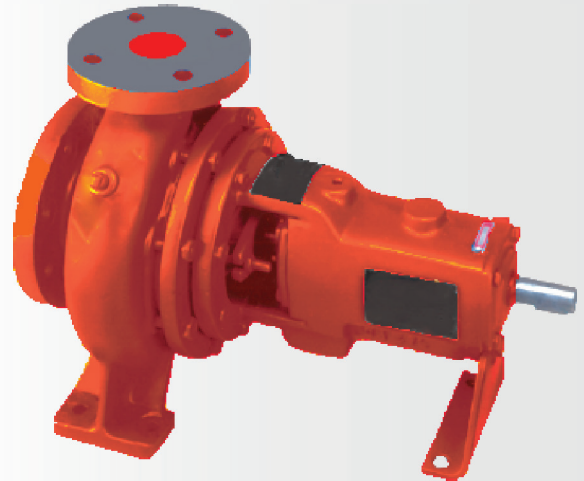

Standard Centrifugal Pump with Packing or Mech Seal

Frame mounted version WP: Up to 550m<sup>3</sup>/h, up to 100m

Closed coupled version WPC: Up to 550m<sup>3</sup>/h, up to 100m

Extended program WPL: Up to 2.100m<sup>3</sup>/h, up to 42m

Temperature range: -10°C up to +100°C

Design pressure: 10bar

Materials: 0.6025, Bronze, Phosphor Bronze

Dimensions: ISO 2258/EN 22858

Design: DIN 24255

Flange: Drilled acc. to DIN, BS, ANSI, JIS

## How to reach us

If you want to visit us personally we would be happy to help to plan your journey.

